

Batch Asphalt Hot Mix Plant Capacity 80t/H

Our Product Introduction

for more products please visit us on sunnyconcretebatchingplant.com

Basic Information

- Place of Origin: Hunan
- Brand Name: Sunny
- Model Number: LB1000
- Minimum Order Quantity: 1 set
- Price: USD250,000-50,0000 PER SET
- Packaging Details: FULL CONTAINER
- Delivery Time: 20-35DAYS
- Payment Terms: L/C, T/T, Western Union, MoneyGram
- Supply Ability: 50 SET PER MONTH



Product Specification

- Warranty: 1 Year
- After-sales Service Provided: Engineers Available To Service Machinery Overseas
- Type: Asphalt Mixing Plant
- Application: High-grade Asphalt Road Paving, Construction Areas, Road Construction Asphalt Plant
- Control System: PLC+colorized Touching Screen
- Highlight: hot mix plant, hot mix asphalt batch plant, asphalt hot mix plant capacity



Product Description

80t/h asphalt hot mixing machine price

The asphalt plant adopts modular design, easy installation and maintenance, fast removal and transportation. It is mainly used for the construction of highways, highways, municipal roads, airports and ports.

Production Capacity: The LB1000 model typically has a production capacity of 80 tons per hour, making it suitable for medium-scale asphalt production.

Mixing System: The plant incorporates a twin-shaft paddle mixer that ensures thorough mixing of aggregates, filler, and bitumen. This results in a high-quality asphalt mixture with excellent consistency and uniformity.

Precise Measurement and Control: The LB1000 plant is equipped with accurate weighing systems for aggregates, filler, and bitumen, ensuring precise dosing. The control system allows for adjustments in mixing ratios and temperature settings, allowing flexibility in producing various asphalt mix designs while maintaining consistent quality.

Model	Rated Output	Mixer Capacity	Dust removal effect	Total power	Fuel consumption	Fire coal	Weighing accuracy	Hopper Capacity	Dryer Size
LB1000	80t/h	1000kg	≤20 mg/Nm³	264kw	5.5-7 kg/t	10kg/t	aggregate; ±5‰	4×8.5m³	φ1.75m×7m
LB1300	100t/h	1300kg		264kw			powder; ±2.5‰	4×8.5m³	φ1.75m×7m
LB1500	120t/h	1500kg		325kw			asphalt; ±2.5‰	4×8.5m³	φ1.75m×7m
LB2000	160t/h	2000kg		483kw				5×12m³	φ1.75m×7m

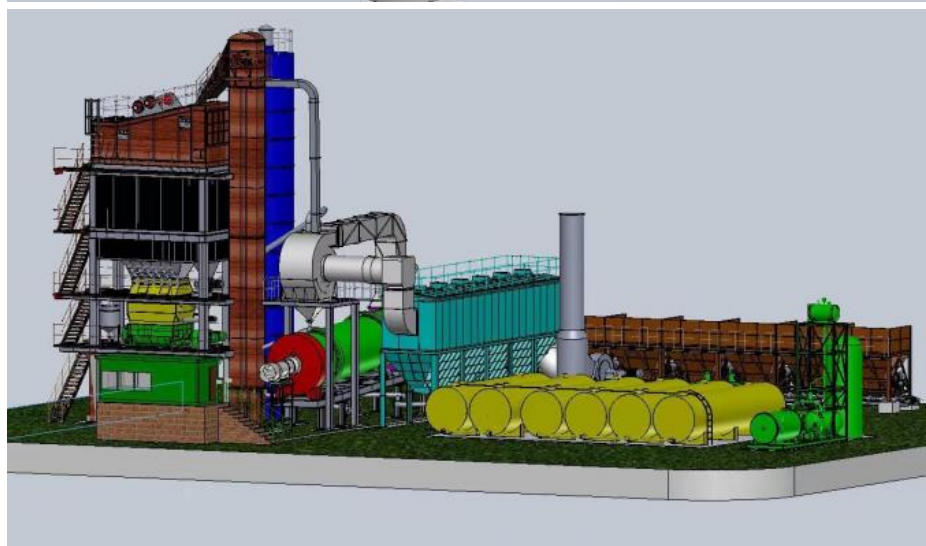
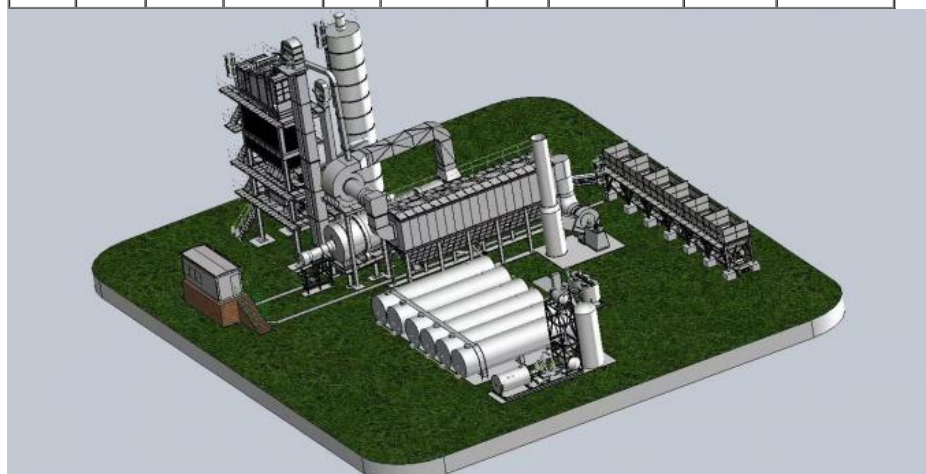

Hunan Sunny Intelligent Machinery Co.,LTD.

+86 19118921276

amy@hnsunny.com.cn

sunnyconcretebatchingplant.com

Construction Machinery Supporting Industrial Park, High-tech Zone, Ningxiang City, Hunan Province