



## 80Ton/Hour Asphalt Concrete Mixing Plant Supplier

Our Product Introduction

for more products please visit us on [sunnyconcretebatchingplant.com](http://sunnyconcretebatchingplant.com)

### Basic Information

- Place of Origin: Hunan
- Brand Name: Sunny
- Model Number: LB1000
- Minimum Order Quantity: 1 set
- Price: USD250,000-50,0000 PER SET
- Packaging Details: FULL CONTAINER
- Delivery Time: 20-35DAYS
- Payment Terms: L/C, T/T, Western Union, MoneyGram
- Supply Ability: 50 SET PER MONTH

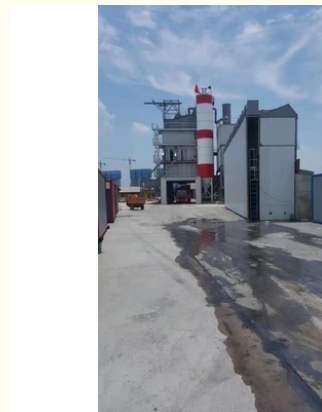

### Product Specification

- Warranty: 1 Year
- After-sales Service Provided: Engineers Available To Service Machinery Overseas
- Type: Asphalt Mixing Plant
- Application: High-grade Asphalt Road Paving, Construction Areas, Road Construction Asphalt Plant
- Control System: PLC+colorized Touching Screen
- Highlight: asphalt mixer plant, asphalt concrete plant mix, asphalt concrete mixing plant

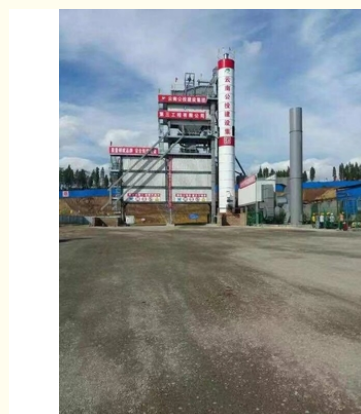

## Product Description

### 80Ton/hour China Asphalt Mixing Plant Supplier

**User-Friendly Design:** The 80tph asphalt mixer plant features user-friendly controls and a well-organized layout, making it easy for operators to monitor and control the asphalt production process. The intuitive interface and clear display enhance operational efficiency and reduce the learning curve for plant operators.

**Mobility Options:** Depending on the specific model and manufacturer, the 80tph asphalt mixer plant may offer mobility options. It can be designed as a stationary plant for long-term projects or as a mobile plant mounted on wheels or trailers for projects that require frequent relocation.

**Durability and Reliability:** The 80tph asphalt mixer plant is constructed with high-quality materials and components to ensure durability and long service life. It is designed to withstand demanding operating conditions and deliver reliable performance over an extended period.

These are some of the typical characteristics of an 80tph asphalt mixer plant. However, it's important to note that specific features and specifications may vary depending on the manufacturer and model. It is recommended to refer to the product catalogs or directly contact asphalt plant manufacturers for detailed information on a particular 80tph asphalt mixer plant.

| Model  | Rated Output | Mixer Capacity | Dust removal effect | Total power | Fuel consumption | Fire coal | Weighing accuracy | Hopper Capacity | Dryer Size |
|--------|--------------|----------------|---------------------|-------------|------------------|-----------|-------------------|-----------------|------------|
| LB1000 | 80t/h        | 1000kg         | ≤20 mg/Nm³          | 264kw       | 5.5-7 kg/t       | 10kg/t    | aggregate; ±5‰    | 4×8.5m³         | φ1.75m×7m  |
| LB1300 | 100t/h       | 1300kg         |                     | 264kw       |                  |           | powder; ±2.5‰     | 4×8.5m³         | φ1.75m×7m  |
| LB1500 | 120t/h       | 1500kg         |                     | 325kw       |                  |           |                   | 4×8.5m³         | φ1.75m×7m  |
| LB2000 | 160t/h       | 2000kg         |                     | 483kw       |                  |           | asphalt; ±2.5‰    | 5×12m³          | φ1.75m×7m  |

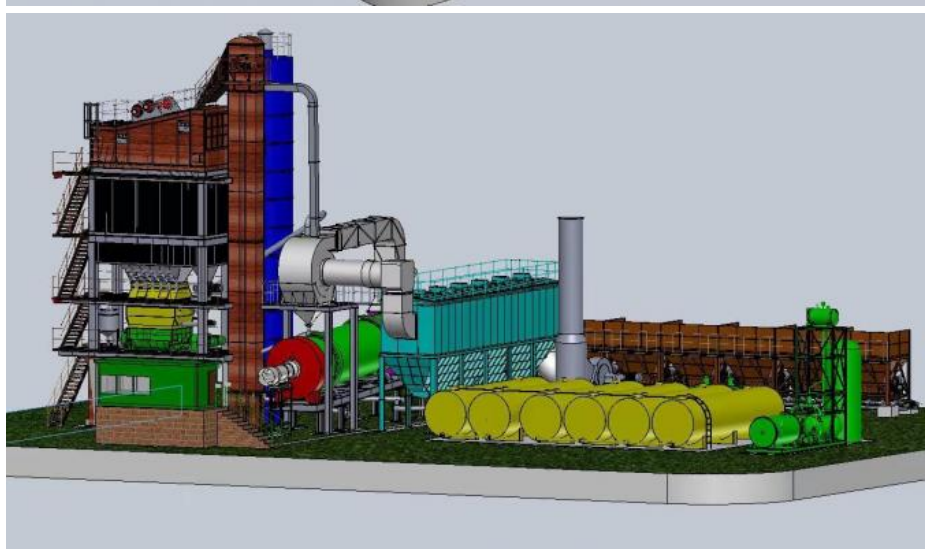

**Hunan Sunny Intelligent Machinery Co.,LTD.**

+86 19118921276

amy@hnsunny.com.cn

[sunnyconcretebatchingplant.com](http://sunnyconcretebatchingplant.com)

Construction Machinery Supporting Industrial Park, High-tech Zone, Ningxiang City, Hunan Province