



120Tph Fixed Asphalt Hot Mix Plant Batching Plant

Our Product Introduction

for more products please visit us on sunnyconcretebatchingplant.com

Basic Information

- Place of Origin: Hunan
- Brand Name: Sunny
- Model Number: LB1500
- Minimum Order Quantity: 1 set
- Price: USD250,000-50,0000 PER SET
- Packaging Details: FULL CONTAINER
- Delivery Time: 20-35DAYS
- Payment Terms: L/C, T/T, Western Union, MoneyGram
- Supply Ability: 50 SET PER MONTH



Product Specification

- Warranty: 1 Year
- After-sales Service Provided: Engineers Available To Service Machinery Overseas
- Type: Asphalt Mixing Plant
- Application: High-grade Asphalt Road Paving, Construction Areas, Road Construction Asphalt Plant
- Control System: PLC+colorized Touching Screen
- Highlight: **asphalt hot mix plant, batching plant asphalt plant, asphalt plant batching plant**



Product Description

120T/H Fixed Hot Mix Asphalt Plant Manufacturer

The LB1500 asphalt plant offers several key advantages that differentiate it from other models in the market. These advantages include:

Optimal Production Capacity: The LB1500 model has a production capacity of 120 tons per hour, making it suitable for medium to large-scale asphalt production. It strikes a balance between high output and versatility, making it a preferred choice for various construction projects.

Efficient Mixing System: The LB1500 asphalt plant incorporates a twin-shaft paddle mixer, ensuring efficient and uniform mixing of aggregates, filler, and bitumen. This results in a high-quality asphalt mixture with excellent consistency and uniformity, which performs well on road surfaces.

Precise Measurement and Control: The LB1500 plant is equipped with advanced weighing systems that ensure accurate and precise dosing of aggregates, filler, and bitumen. The control system allows for adjustments in mixing ratios and temperature settings, providing flexibility to produce different asphalt mix designs while maintaining consistent quality.

Model	Rated Output	Mixer Capacity	Dust removal effect	Total power	Fuel consumption	Fire coal	Weighing accuracy	Hopper Capacity	Dryer Size
LB1000	80t/h	1000kg	≤20 mg/Nm³	264kw	5.5-7 kg/t	10kg/t	aggregate; ±5‰	4×8.5m³	φ1.75m×7m
LB1300	100t/h	1300kg		264kw			powder; ±2.5‰	4×8.5m³	φ1.75m×7m
LB1500	120t/h	1500kg		325kw			±2.5‰	4×8.5m³	φ1.75m×7m
LB2000	160t/h	2000kg		483kw			asphalt; ±2.5‰	5×12m³	φ1.75m×7m

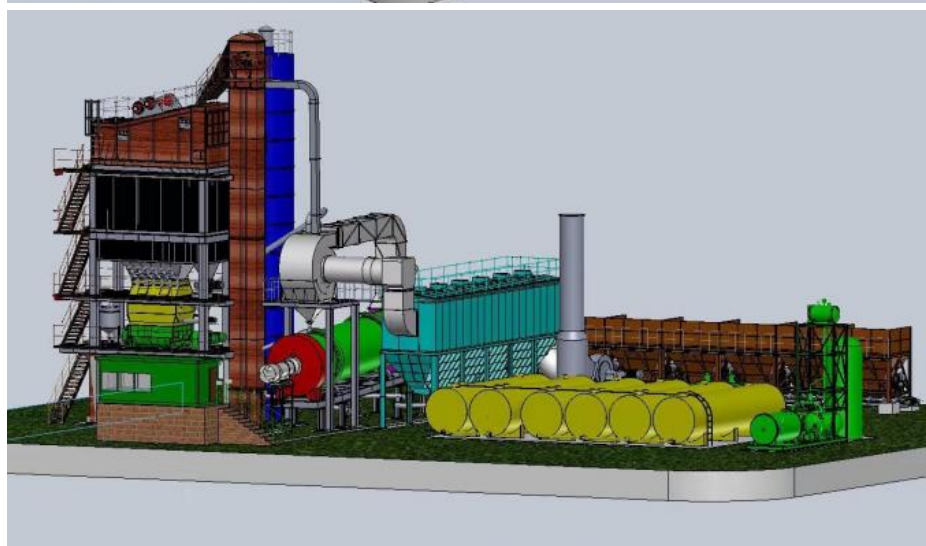

Hunan Sunny Intelligent Machinery Co.,LTD.

+86 19118921276

amy@hnsunny.com.cn

sunnyconcretebatchingplant.com

Construction Machinery Supporting Industrial Park, High-tech Zone, Ningxiang City, Hunan Province