



120TPH Stationary Bitumen Hot Mix Plant From China Manufacturer

Our Product Introduction

Basic Information

- Place of Origin: Hunan
- Brand Name: Sunny
- Model Number: LB1000
- Minimum Order Quantity: 1 set
- Price: USD250,000-50,0000 PER SET
- Packaging Details: FULL CONTAINER
- Delivery Time: 20-35DAYS
- Payment Terms: L/C, T/T, Western Union, MoneyGram
- Supply Ability: 50 SET PER MONTH



Product Specification

- Warranty: 1 Year
- After-sales Service Provided: Engineers Available To Service Machinery Overseas
- Type: Asphalt Mixing Plant
- Application: High-grade Asphalt Road Paving, Construction Areas, Road Construction Asphalt Plant
- Control System: PLC+colorized Touching Screen
- Highlight: bitumen hot mix plant, bitumen mixing plant, bitumen plant



Product Description

120TPH Stationary Hot Mix Bitumen Plant from China Manufacturer

The LB1500 asphalt plant is a highly efficient and reliable asphalt mixing plant designed for large-scale asphalt production. It is part of the LB series of asphalt plants, known for their advanced technology and superior performance. The LB2000 model specifically offers a range of features and capabilities that make it a popular choice among asphalt producers.

The LB1500 asphalt plant is designed to handle a substantial volume of asphalt production. It has a production capacity of 160 tons per hour, making it suitable for medium to large-scale projects such as highways, airports, and major road construction.

One of the key features of the LB2000 model is its precise and efficient mixing system. It utilizes a twin-shaft paddle mixer, which ensures thorough blending of aggregates, filler, and bitumen. This results in a high-quality asphalt mixture with excellent uniformity and consistency, meeting the required specifications for road surfaces.

Model	Rated Output	Mixer Capacity	Dust removal effect	Total power	Fuel consumption	Fire coal	Weighing accuracy	Hopper Capacity	Dryer Size
LB1000	80t/h	1000kg	≤20 mg/Nm³	264kw	5.5-7 kg/t	10kg/t	aggregate; ±5‰	4×8.5m³	φ1.75m×7m
LB1300	100t/h	1300kg		264kw			powder; ±2.5‰	4×8.5m³	φ1.75m×7m
LB1500	120t/h	1500kg		325kw				4×8.5m³	φ1.75m×7m
LB2000	160t/h	2000kg		483kw			asphalt; ±2.5‰	5×12m³	φ1.75m×7m

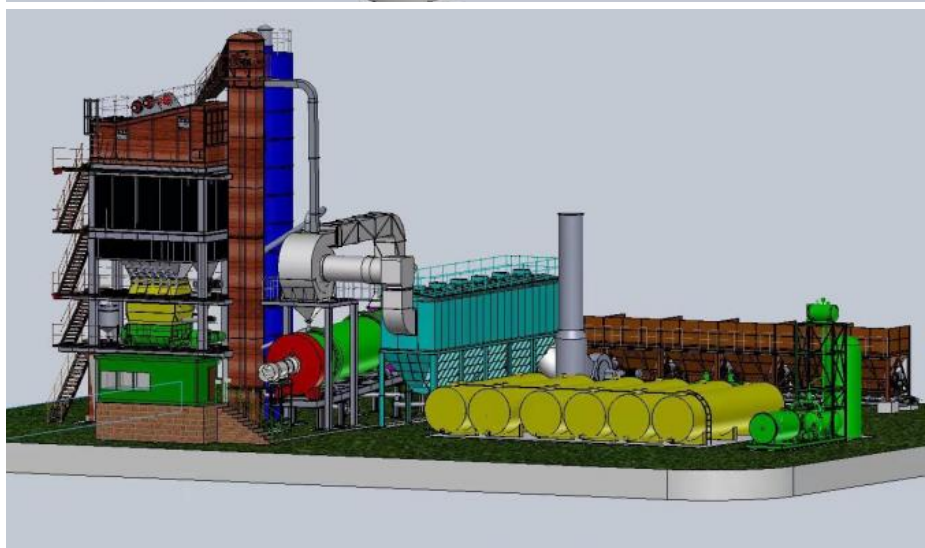

Hunan Sunny Intelligent Machinery Co.,LTD.

+86 19118921276

amy@hnsunny.com.cn

sunnyconcretebatchingplant.com

Construction Machinery Supporting Industrial Park, High-tech Zone, Ningxiang City, Hunan Province