



160T/H Environmentally-friendly Stationary Batch Mix Asphalt Plant

Basic Information

- Place of Origin: Hunan
- Brand Name: Sunny
- Model Number: LB2000
- Minimum Order Quantity: 1 set
- Price: USD250,000-50,0000 PER SET
- Packaging Details: FULL CONTAINER
- Delivery Time: 20-35DAYS
- Payment Terms: L/C, T/T, Western Union, MoneyGram
- Supply Ability: 50 SET PER MONTH



Product Specification

- Warranty: 1 Year
- After-sales Service Provided: Engineers Available To Service Machinery Overseas
- Type: Asphalt Mixing Plant
- Application: High-grade Asphalt Road Paving, Construction Areas, Road Construction Asphalt Plant
- Control System: PLC+colorized Touching Screen
- Highlight: **Stationary Batch Mix Asphalt Plant, Environmentally-friendly Batch Mix Asphalt Plant, 160T/H Batch Mix Asphalt Plant**



Our Product Introduction

for more products please visit us on sunnyconcretebatchingplant.com

Product Description

The LB2000 asphalt plant is a highly efficient and reliable asphalt mixing plant designed for large-scale asphalt production. It is part of the LB series of asphalt plants, known for their advanced technology and superior performance. The LB2000 model specifically offers a range of features and capabilities that make it a popular choice among asphalt producers.

The LB2000 asphalt plant is designed to handle a substantial volume of asphalt production. It has a production capacity of 160 tons per hour, making it suitable for medium to large-scale projects such as highways, airports, and major road construction.

1. Modular design and integrity steel base, reasonable layout, demolition, transportation and installation faster and easier.
2. Superior drying drum plate design, and independent research and development of advanced combustion heating technology to improve efficiency, reduce energy consumption.
3. Plus high hot aggregate bin design to increase the stock of hot aggregate storage, to increase producing capacity.

Model	Rated Output	Mixer Capacity	Dust removal effect	Total power	Fuel consumption	Fire coal	Weighing accuracy	Hopper Capacity	Dryer Size
LB1000	80t/h	1000kg	≤20 mg/Nm³	264kw	5.5-7 kg/t	10kg/t	aggregate; ±5‰	4×8.5m³	φ1.75m×7m
LB1300	100t/h	1300kg		264kw			powder; ±2.5‰	4×8.5m³	φ1.75m×7m
LB1500	120t/h	1500kg		325kw			asphalt; ±2.5‰	4×8.5m³	φ1.75m×7m
LB2000	160t/h	2000kg		483kw				5×12m³	φ1.75m×7m

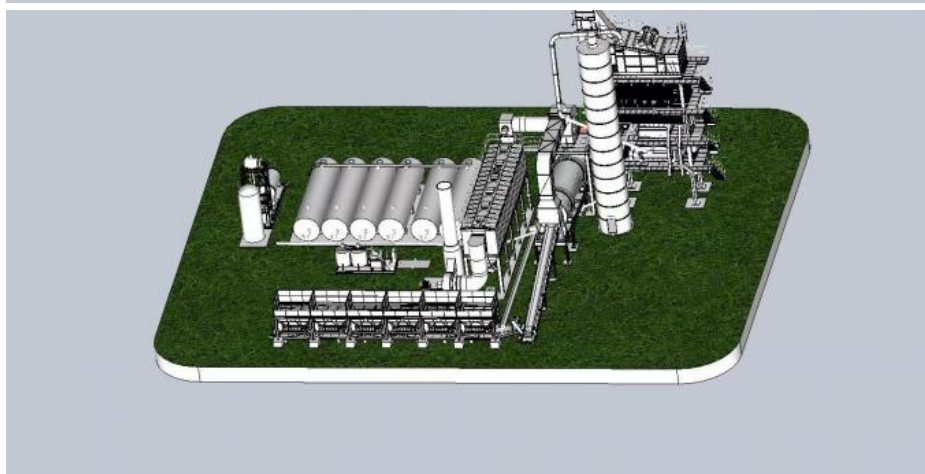
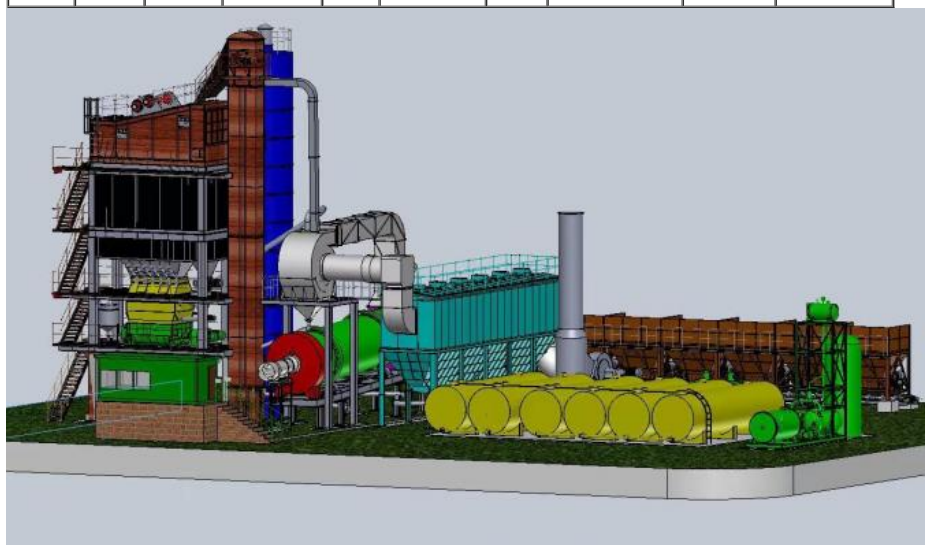

Hunan Sunny Intelligent Machinery Co.,LTD.

+86 19118921276

amy@hnsunny.com.cn

sunnyconcretebatchingplant.com

Construction Machinery Supporting Industrial Park, High-tech Zone, Ningxiang City, Hunan Province